



FAG

61806-2Z

Deep groove ball bearing

Schaeffler ID:
0554560730000Deep groove ball bearing 618.-2Z, single
row, shields, steel sheet metal cage

Technical information

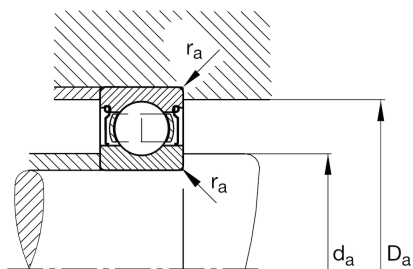
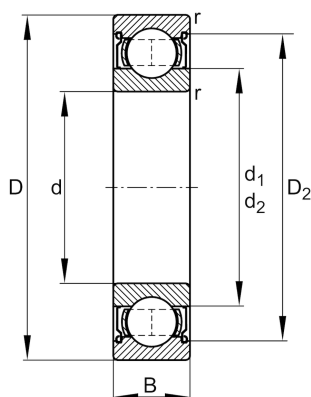
**Main Dimensions & Performance Data**

d	30 mm	Bore diameter
D	42 mm	Outside diameter
B	7 mm	Width
C_r	4.450 N	Basic dynamic load rating, radial
C_{0r}	3.440 N	Basic static load rating, radial
C_{ur}	154 N	Fatigue load limit, radial
n_G	20.800 1/min	Limiting speed
n_{gr}	11.500 1/min	Reference speed
	20 g	Weight

Dimensions

r_{min}	0,3 mm	Minimum chamfer dimension
D_2	39,2 mm	Caliber diameter outer ring
d_1	33,1 mm	Shoulder diameter inner ring

Mounting dimensions

$d_{a min}$	32 mm	Minimum diameter shaft shoulder
$D_{a max}$	40 mm	Maximum diameter of housing shoulder
$r_{a max}$	0,3 mm	Maximum fillet radius

Calculation factors

f_0	16,5	Calculation factor
-------	------	--------------------

Temperature range

T_{min}	-30 °C	Operating temperature min.
T_{max}	120 °C	Operating temperature max.